

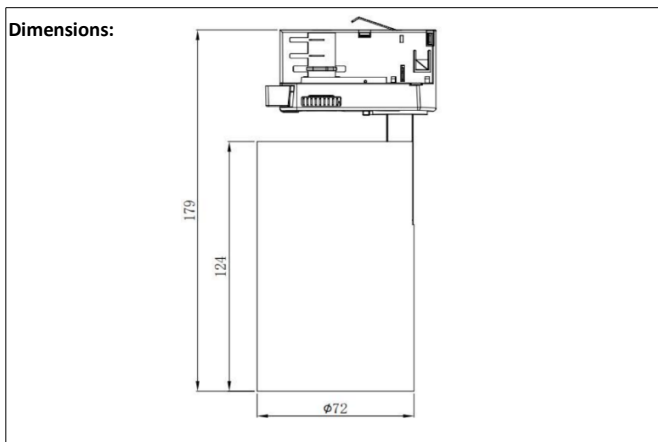

B12 LED Track Light 19W

B12 LED luminaire is an option for customers who are looking for alternatives of metal halide luminaires mounted on the 3-phase lighting tracks. The solution is a functional replacement which delivers the equivalent amount of light at a significantly reduced demand for electricity. Heart of the fixture, is the LED COB module made by Bridgelux. Fixture is available in many variants - resulting from a combination of parameters.



TRIDONIC

Code*:	CCT/CRI:	Φ Fixture:	Housing:
497-932-CX610B	3200K/96	2520lm	black
497-132-CX610B	3200K/96	2520lm	white

*x (beam angle) 1-18°, 2-28°, 3-36°, 5-50° (eg. 497-932-C2610B = 28°)

Additional picture:

Parameters:
power factor (PF): >0,95
power: 19W
voltage: 230V AC (via 3-phase track)
beam angle: 18°, 28°, 36° or 50°
light source: COB LED Bridgelux
efficiency: up to 135lm/W
SDCM: 2
lifespan L80/B50/C10: 40.000 hours (according to IEC 62717 norm)
operating temperature range: from 0°C to +30°C
CRI (Ra): CRI96
Re: 94,7
IP rate: IP20
compatible with track lights: GLOBAL trac, Unipro, etc.

Dimensions:
diameter: 72mm
length: 124mm

Material:
aluminium housing + PCV
weight: 0,40kg

photometric data presented with a tolerance +/- 7%

